

## Labels for Brady IP series and 5100 printers

### THT labels on large mandrels

(\*external label holder option required)

A: width; B: height; C: printable area

Cat. No.	Type	B x A (C) (mm)	Cat. No. Brady	Qty/ roll	€
<b>0.5 to 0.7 ml microcentrifuge tubes (fig. A)</b>					
167338	s	12.70 x 19.05	THT-68-499-10	10000	NC -
167331	s	9.53 x 25.40	THT-152-499-3	3000	NC -
167313	w	9.53 x 45.72 (19.05)	THT-123-461-3	3000	NC -
167312	w	12.70 x 45.72 (19.05)	THT-123-461-3	3000	NC -
167316	w	12.70 x 55.88 (19.05)	THT-127-427-3	3000	NC -
167146	w	12.70 x 55.88 (19.05)	THT-127-461-3	3000	NC -
<b>1.5 to 2 ml microcentrifuge tubes (fig. A)</b>					
167315	s	22.86 x 12.70	THT-126-499-3	3000	NC -
167318	w	15.24 x 41.28 (25.40)	THT-133-461-3	3000	NC -
167316	w	12.70 x 55.88 (19.05)	THT-127-427-3	3000	NC -
167146	w	12.70 x 55.88 (19.05)	THT-127-461-3	3000	NC -
167332	w	15.24 x 66.68 (25.40)	THT-153-461-3	3000	NC -
167901	t	9.53 x 25.40 (Ø 9.53)	THT-163-499-3	3000	NC -
<b>Conical tubes 14 to 15 ml (fig.B)</b>					
167319	w	38.10 x 88.90 (31.75)	THT-134-461-3	3000	NC -
<b>Conical tubes / Bottles / Petri dishes / Microplates (fig.B)</b>					
167335	s	6.35 x 25.40	THT-51-423-10	10000	NC -
167337	s	12.70 x 25.40	THT-5-423-10	10000	NC -
167320	s	19.05 x 38.10	THT-135-427-AW-3	3000	NC -
167321	s	19.05 x 38.10	THT-136-499-3	3000	NC -
167322	s	25.40 x 50.80	THT-137-427-AW-3	3000	NC -
167323	s	25.40 x 50.80	THT-137-499-3	3000	NC -
167324	w	25.40 x 133.35 (38.10)	THT-139-461-2	2000	NC -
<b>Tubes / Flasks 0.6 ml (fig.C)</b>					
167338	s	12.70 x 19.05	THT-68-499-10	10000	NC -
167314	s	12.70 x 22.86	THT-125-499-3	3000	NC -
167316	w	12.70 x 55.88 (19.05)	THT-127-427-3	3000	NC -
167146	w	12.70 x 55.88 (19.05)	THT-127-461-3	3000	NC -
<b>Tubes / Flasks of 1 to 2 mm (fig.C)</b>					
167315	t	22.86 x 12.70 (12.70)	THT-126-499-3	3000	NC -
167318	w	15.24 x 41.28 (25.40)	THT-133-461-3	3000	NC -
167332	w	15.24 x 66.68 (25.40)	THT-153-461-3	3000	NC -
167317	w	25.40 x 66.68 (25.40)	THT-131-427-3	3000	NC -
167261	w	25.40 x 66.68 (25.40)	THT-131-461-3	3000	NC -
<b>Tubes / Flasks of 4 to 8 mm (fig.C)</b>					
167317	w	25.40 x 66.68 (25.40)	THT-131-427-3	3000	NC -
167261	w	25.40 x 66.68 (25.40)	THT-131-461-3	3000	NC -
<b>Tubes / Flasks of 12 to 24 mm (fig.C)</b>					
167319	w	38.10 x 88.90 (31.75)	THT-134-461-3	3000	NC -
167324	w	25.40 x 133.35 (38.10)	THT-139-461-2	2000	NC -
<b>Tube caps / 0.6 ml flasks (fig.D)</b>					
167328	l	(Ø 9.53)	THT-143-499-3	3000	NC -
<b>Tube caps / 1 to 2 ml flasks (fig.D)</b>					
167329	l	(Ø 12.70)	THT-144-499-3	3000	NC -
167315	x	22.86 x 12.70 (Ø 12.70)	THT-126-499-3	3000	NC -
<b>Coverslips (fig. E)</b>					
167902****	s	22.86 x 22.86	THT-141-481-3	3000	NC -
167903****	s	19.65 x 22.86	THT-194-481-3	3000	NC -
167904****	s	9.53 x 22.86	THT-195-481-3	3000	NC -
167325	s	19.05 x 22.86	THT-140-488-3	3000	NC -
167326	s	22.86 x 22.86	THT-141-488-3	3000	NC -
<b>Microplates (fig. F)</b>					
167333	s	6.35 x 50.80	THT-15-423-2.5	2500	NC -
167330	s	6.35 x 50.80	THT-151-499-3	3000	NC -
167327	s	5.08 x 63.50	THT-142-423-2.5	2500	NC -
<b>Sealed flasks (fig. G)</b>					
167336	s	12.70 x 25.40	THT-5-351-10	10000	NC -
167334	s	25.40 x 50.80	THT-17-351-3	3000	NC -
<b>Microcentrifuge tubes (fig. H) in matt white polyester Freezer Bondz, suitable for identification of frozen tubes**</b>					
167160	s	9.53 x 31.75	THT-154-490-3	3000	NC -
167161	s	15.24 x 41.28	THT-155-490-3	3000	NC -
167162	s	25.40 x 48.26	THT-156-490-3	3000	NC -
167163	s	38.10 x 55.88	THT-157-490-3	3000	NC -
167164	s	38.10 x 95.25	THT-158-490-3	3000	NC -
<b>Centrifuge microtubes (fig. H) Freezer Bondz, II suitable for identification of all frozen surfaces***</b>					
167853	l	9.53 mm	THT-143-492-3	3000	NC -
167854	l	12.7 mm	THT-144-492-3	3000	NC -
167365	s	48.26 x 25.4 mm	THT-156-492-3	3000	NC -
167634	s	25.4 x 25.4 mm	THT-179-492-3	3000	NC -
167635	s	22.86 x 22.86 mm	THT-180-492-3	3000	NC -
167636	x	25.4 x 12.7 mm (Ø 9.53)	THT-181-492-3	3000	NC -
167637	x	25.4 x 12.7 mm (Ø 12.18)	THT-182-492-3	3000	NC -
167855	s	25.4 x 12.7 mm	THT-59-492-10	10000	NC -
167974	-	25.40 x 19.05	THT-88-492-5	5000	NC -
814347	-	41.28 x 15.24 (Ø 9.53)	THT-190-492-3	3000	NC -
814348	-	41.28 x 15.24	THT-155-492-3	3000	NC -
167632	-	25.40 x 9.53	THT-152-492-3	3000	NC -
167634	-	25.40 x 25.40	THT-179-492-3	3000	NC -
167633	-	25.40 x 9.53 (Ø 9.53)	THT-163-492-3	3000	NC -

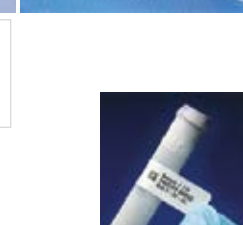
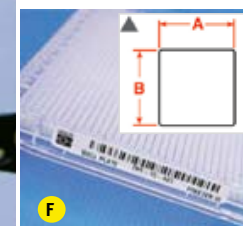
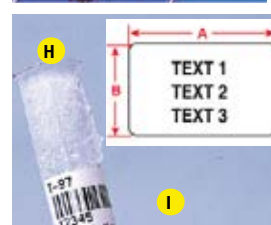
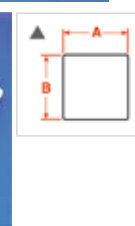
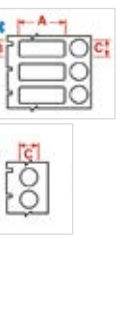
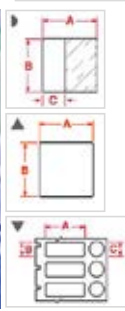
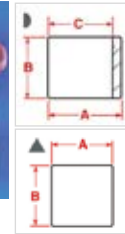
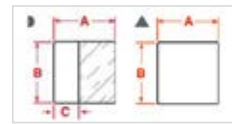

IDENTIFICATION, PROTECTION, WASTE MANAGEMENT

HEALTH AND SAFETY

All prices are indicative and exclude VAT. Visit www.dulis.nl

\*\* Overlapping of both ends of the label is mandatory. \*\*\* No obligation to overlap the two ends of the label. \*\*\*\* Very high solvent resistance